

Digital Room Thermostat

Operating & Installation Manual

1. DESCRIPTION

The Brivis Digital Room Thermostat is an easy to operate manual thermostat.

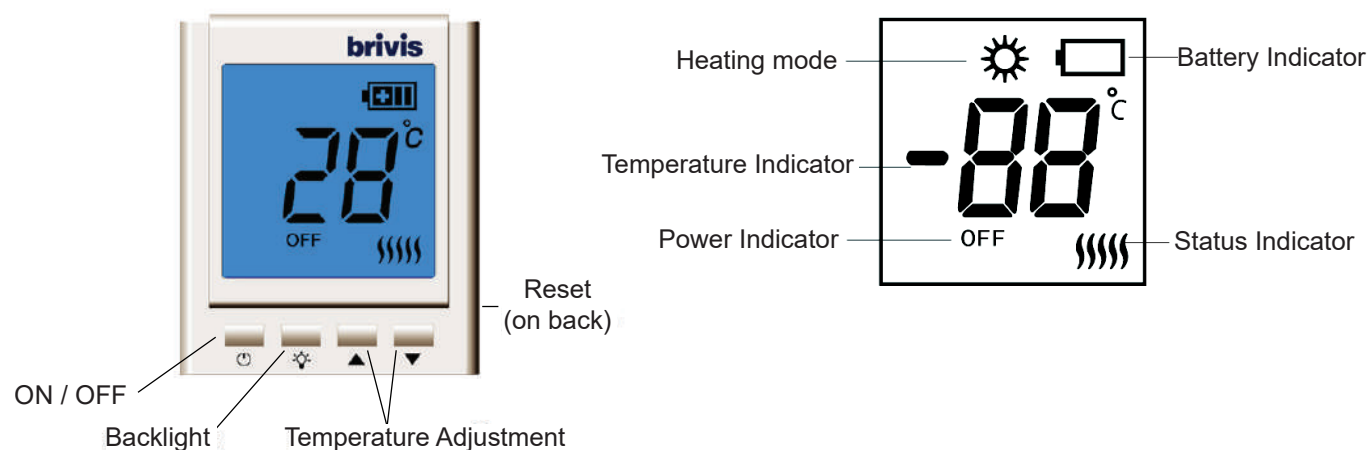

2. MAIN FEATURES

Power Source:	2 x 1.5V AA Battery
Battery Life:	1 year (typical operation)
Protection Class:	IP30
Switch Function / Capacity:	36V AC or DC, 1.0 Amp maximum
Temperature Set-point Range:	5°C to 35°C
Temperature Display Range:	-9°C to 50°C
Temperature Control Accuracy:	1°C
Returned Temperature:	1°C
Storage Temperature Range:	-20°C to 70°C
Dimensions:	100mm (L) x 85mm (W) x 25mm (H)
Weight:	180 grams (excluding batteries)

3. SPECIFICATIONS (ELECTRICAL DATA)

1.	0 to 36Vac 50/60Hz or DC
2.	0.05 to 1.0 Amps (load per terminal)
3.	1.0 Amps Maximum Total (all terminals)

1. Start-up

Fit the battery, press , the LCD flashes with the set temperature, then displays the working mode icon and environment temperature (factory default set temperature is 18°C).

2. Power-off

Pressing  powers the thermostat on / off. Whilst off the current environment temperature remains on display.

3. Backlight

Press , ▲ or ▼, to enable the backlight. The backlight will go off several seconds after last button press.

4. Setting Temperature

Press ▲ or ▼ to set the temperature.

5. Working status

This symbol ||||| indicates that the thermostat is heating.

6. Restore factory defaults

Press the [RESET] button on the back of the thermostat to restore factory defaults.

7. Low battery indicator

When the low battery  indicator flashes replace the batteries immediately.

4. WIRING & INSTALLATION

Wiring

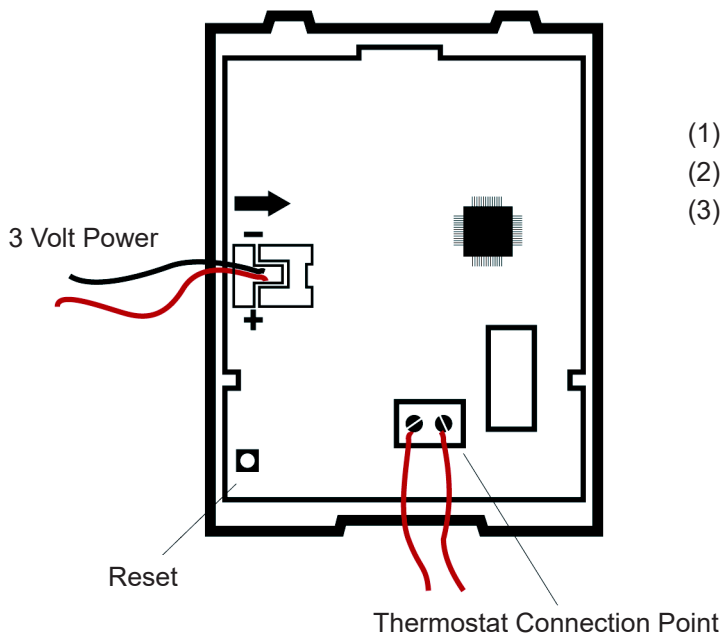
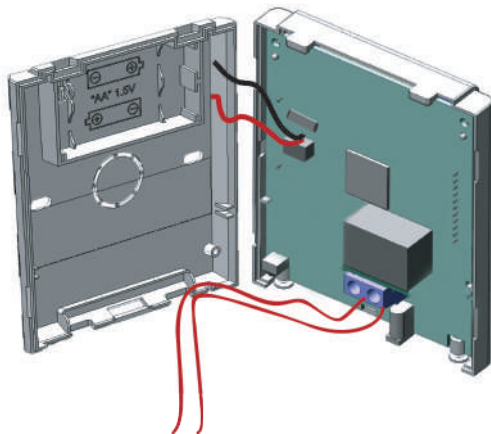

Installation

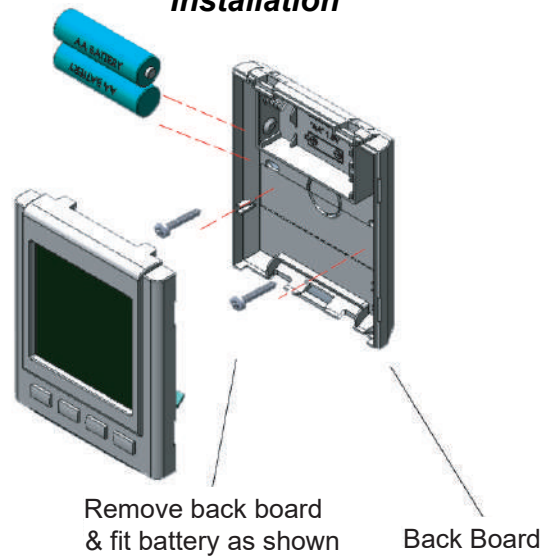

- (1) Fix the back board onto a wall
- (2) Insert batteries into the thermostat
- (3) Attach the thermostat to the backboard

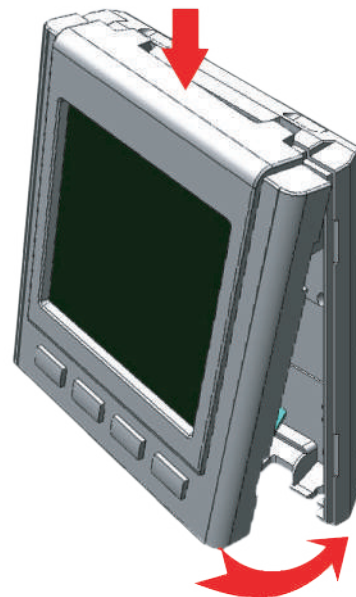

Rinnai Australia Pty Ltd

ABN 74 005 138 769 | AU24752

100 Atlantic Drive, Keysborough, Victoria 3173

P.O. Box 460, Braeside, Victoria 3195

Tel: (03) 9271 6625 Fax: (03) 9271 6622

National Help Line

Tel: 1300 555 545* Fax: 1300 555 655

Monday to Friday, 8.00 am to 5.00 pm EST.

*Cost of a local call higher from mobile or public phones.

For further information visit www.rinnai.com.au
or email enquiry@rinnai.com.au